



Fitting Instructions

TOWBAR R42Q
For MG6
2011-

MATERIALS

A	1	Cross Bar
B	2	M12 x 45 x 1.75 Bolts, Lock Washers, Flat Washers, Cage Nut Retainers & Square Nuts
C	2	Side Bracket
D	2	Cage Nut Carrier
E	2	M8 x 1.25 Spigot Nut, 10mm I.D. Lock Washers and 10mm I.D. Flat Washers (2off)
F	2	Side Arm Brace
G	4	M8 x 30 x 1.25 Bolts, Lock Washers, and Flat Washers
H	4	M12 x 45 x 1.75 Bolts, Lock Washers, and Serrated Flange Nuts
J	8	M8 x 30 x 1.25 Bolts, Lock Washers, and Nuts
K	2	M12 x 25 x 1.75 Bolts, Lock Washers, Flat Washers, Cage Nut Retainers & Square Nuts
L	2	M8 x 30 x 1.25 Bolts, Lock Washers, Flat Washers, and Nuts
ZE	1	Electrical Plate Bracket (ZEQ4)
ZP	1	Flip-Up Electrical Plate Kit (Z99)
ZQ	1	Detachable Neck.

For use with:

R42Q Detachable neck – ZQ3008. Please refer to ZQ fitting instructions for installation

FITTING

1. Remove rear light clusters to gain access to top-corner bumper securing screw (4 nuts, access via boot side trim covers)
2. Remove bumper. (Plastic clips along bottom edge, 1 wheel arch screw, 1 screw under each light cluster, 5 screws along top edge of bumper, 2 plastic clips & 2 screws along bottom edge)
3. Remove Inner Bumper beam.
4. Remove Foam blocks from inside each chassis rail.
5. Lower exhaust silencer to improve access to TowBar mounting points (2 exhaust rubbers).
6. Pre-Assemble each Side Arm (C) as follows:
 - a. Assemble each Cage Nut Carrier (D) over the bent end of each Side Arm (C).
 - b. Assemble a Cage Nut to the Cage Nut Carrier (D), using Cage Nut Fitting Instructions.
 - c. Assemble a second Cage Nut to Side Arm (C), using Cage Nut Fitting Instructions
 - d. Assemble Side Arm Brace (F) to Side Arm (C) using fasteners (J). **Fully tighten fasteners (J)**
7. Insert Side Brackets (C) into open ends of chassis rails, ensuring that they also locate over existing Bumper Beam studs protruding from the rear panel.

Note: When the Side Arms (C) are almost fully inserted, re-insert the foam blocks into the end of each chassis rail so that they seal the chassis aperture.
8. Loosely secure Side Brackets using fasteners (B & K).
9. Loosely assemble Spigot Nut fasteners (E) and associated washers onto the existing studs protruding through Side Brackets (C). The smaller diameter of the Spigot Nut is intended to protrude through its washer and into the hole in the Side Brackets.
10. Assemble the remaining fasteners (L & G) through holes in Side Brackets (C) and vehicle rear panel.
11. Assemble Cross Bar (A) to Side Brackets (C) using fasteners (H).
12. Assemble the Towball Neck (ZQ), Electrical Plate Bracket (ZE) and Flip-Up Electrical Plate Kit (EP) to Cross Bar (A) using fasteners from the Neck kit (ZQ).
13. **Fully tighten all Fasteners** – starting with fasteners (E, L & G).
14. Re-locate exhaust silencer. (Fit rear-most exhaust rubber over the Bracket which is integral to the TowBar.)
15. Cut bumper as shown and re-fit.

Recommended torque settings:

Grade 8.8 bolts: M8 - 24Nm, M10 - 52 Nm, M12 - 80 Nm, M14 - 130 Nm, M16 - 200 Nm

Grade 10.9: M12 – 120Nm, M10 – 70Nm M8- 35Nm



W0001R42Q-FIT\$051108120000

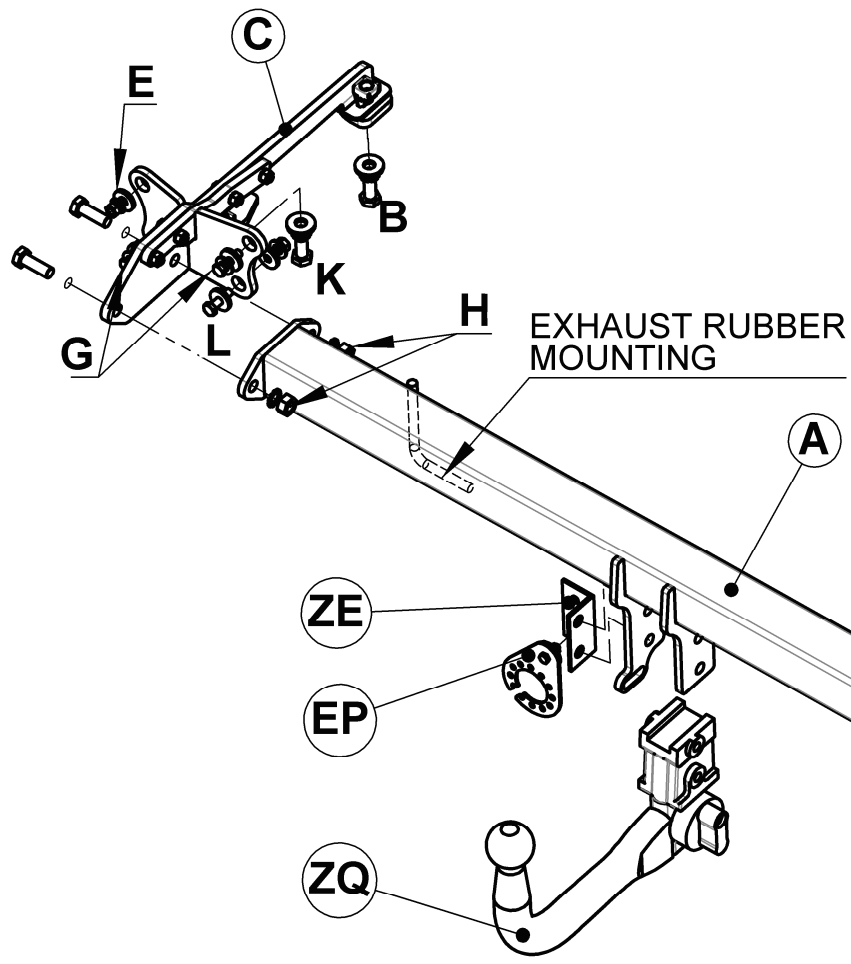

SPIGOT NUT DETAIL

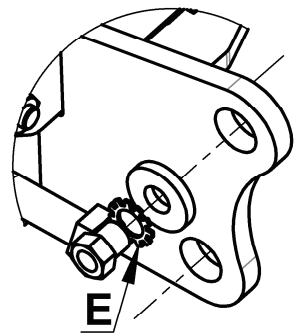

PRE-ASSEMBLED SIDE-ARM

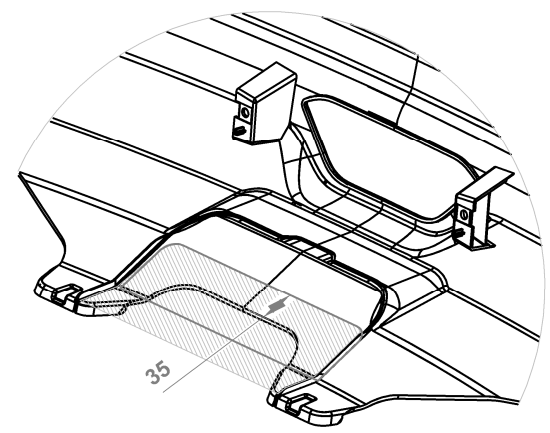
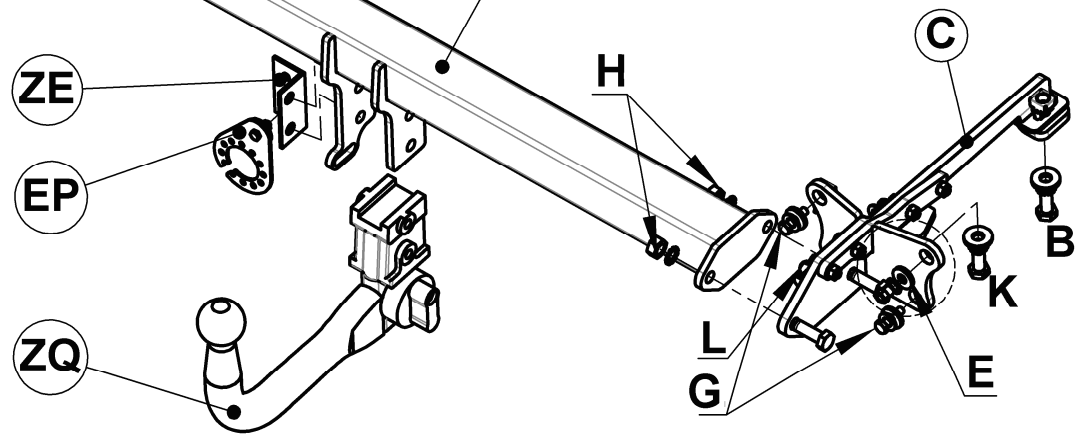
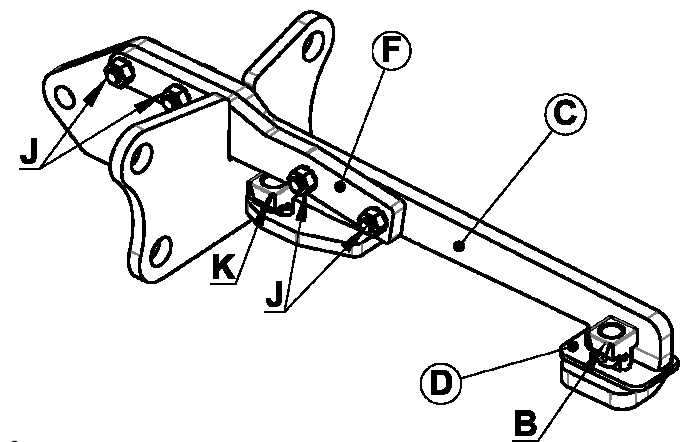

BUMPER CUT SHOWN HATCHED



W0001R42Q-FIT\$051108120000